

Proposed Project at Mouza-Ichlabad, J.L. No-75, L.R. Plot No-570, L.R. Khatian No-1250/2, 8749, 8747, 9336, 9337, 14120, R.S. Plot No-221, R.S. Khatian No-903, Mahalla-Bara Bene Para, Holding No-113, Ward No-10, under Burdwan Municipality, P.S.-Bardhaman, District-Purba Bardhaman

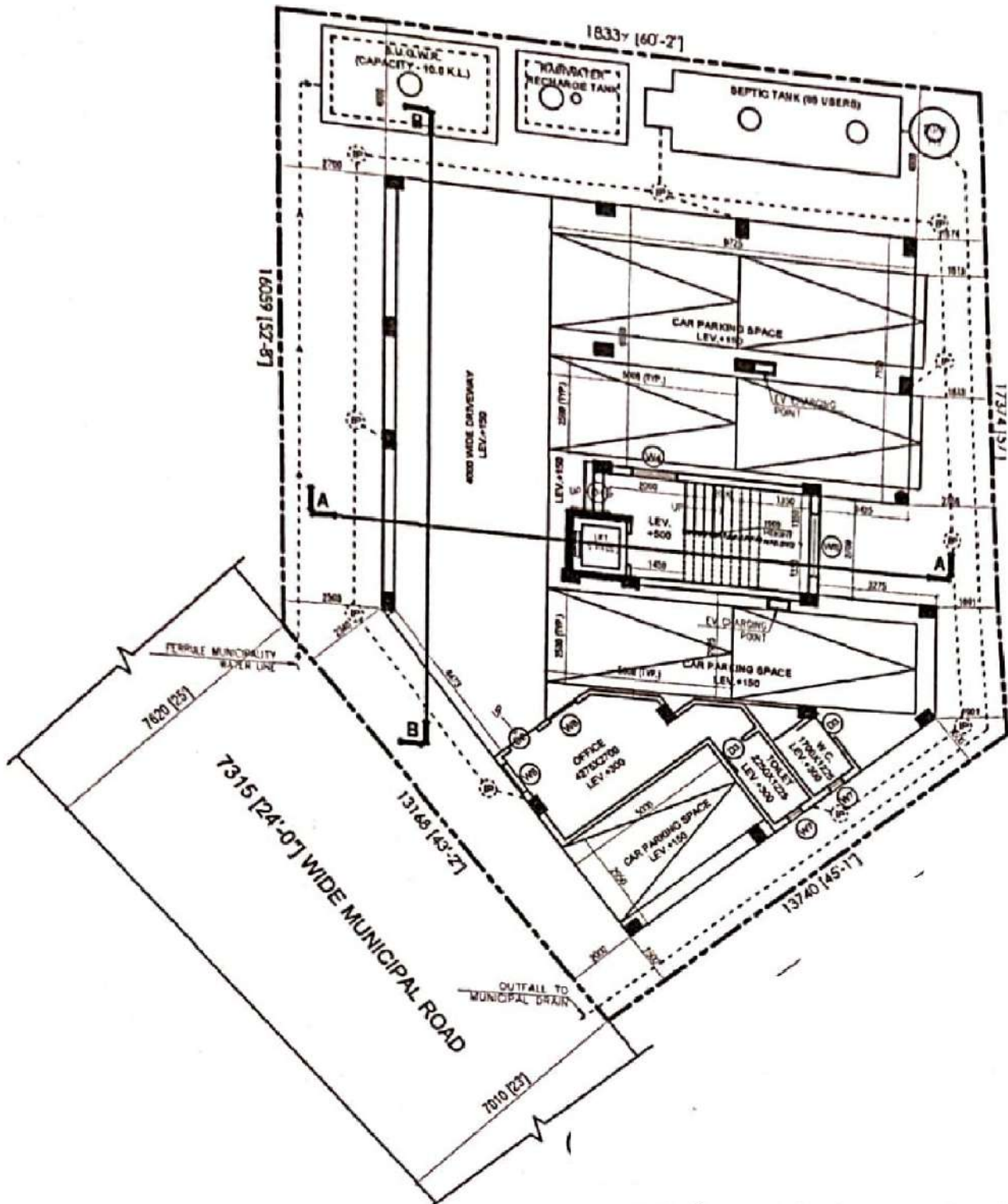

LATITUDE : 22.932294  
 LONGITUDE : 87.775764

**GREEN APPY**  
*Soumitra Adak*  
 Partners

\_\_\_\_\_  
 SIGNATURE OF OWNER